

Freestanding Model 3

Product Description

Large premium water purifier that offers options for Hot, Cold, and Ambient temperature water. Unit is certified to UL 399 and CAN/CSA C22.2 No. 120. Lead-free design which is certified to remove 83 contaminants. Includes UV Light to reduce bacterial and algae growth in the Filtered Water Tank. Meets NSF/ANSI 61 & 372 (lead free) and meets Federal and State low-lead requirements.

Product Specifications

Model number	ATFS-3
Water	Hot, Cold, and Ambient
Filter Stages	Sediment, Pre-Carbon, RO, VOC Carbon, UV, Mineralization, Alkalinization
Finish	Vacuum Formed Plastic and Coated Steel
Power	120 VAC 60hz
MAX Current	10A
Activation by	Button Press or Touch Free Sensor
Mounting Type	Free Standing
Chilling Capacity*	10 GPH
Cooling Power	100W
Heating Power	1000W
Dimensions (L x W x H)	66" X 18.5" X 18.42"
Approx. Shipping Weight	88.8lbs
Installation Location	Indoor only
No. of People Served	More than 100
Water Dispense Rate	0.8 GPM

*Chilling Capacity is based on ASHRAE 18 Testing conditions with 80°F inlet water and 90°F Ambient temperature.

OPTIONAL EARTHQUAKE BRACKET

Complies with ADA 308.2 accessibility requirements when installed according to the requirements outlined in these standards. Installation Instructions (PDF)

Product Certified to Below Standards

NSF/ANSI 42, 53, 58, 401, P472, 61 (Q₁), & 372 (lead free) by IAPMO R&T

UL 399 by SGS



PART: _____ QTY: _____

PROJECT: _____

CONTACT: _____

DATE: _____

NOTES: _____

APPROVAL: _____

Freestanding Model 3

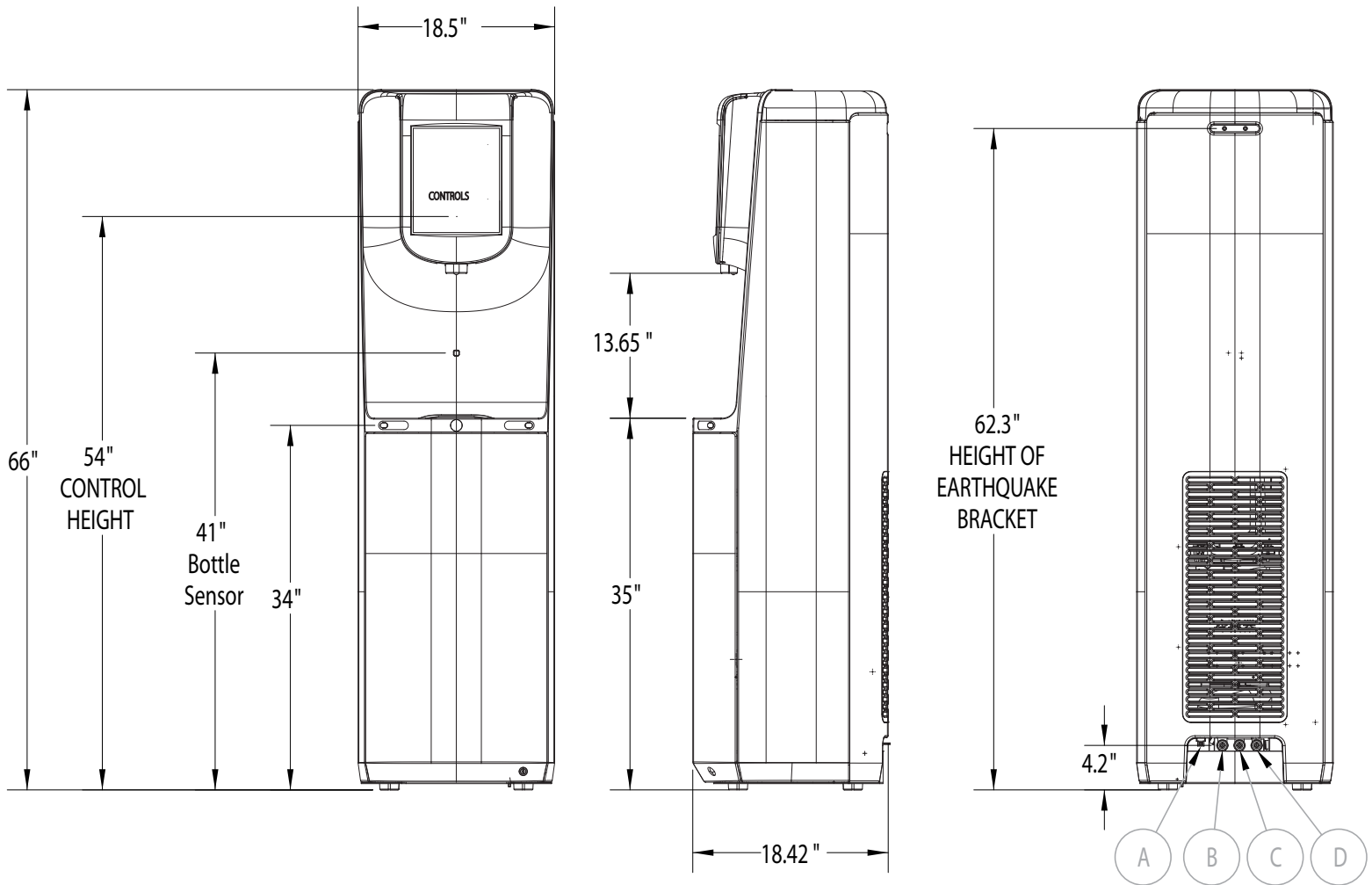

LEAVE AT LEAST 2 INCHES OF SPACE BEHIND THE WATERCOOLER FOR AIR FLOW AND PLUMBING CONNECTIONS

PLUMBING CONNECTIONS ARE 3/8" QUICK CONNECT FITTINGS

- A. ELECTRICAL CORD
- B. TANK DRAIN LINE (USED FOR MAINTNENCE ONLY)
- C. INLET
- D. RO WASTE LINE (MUST BE PLUMBED INTO MUNICIPAL SEWER)